

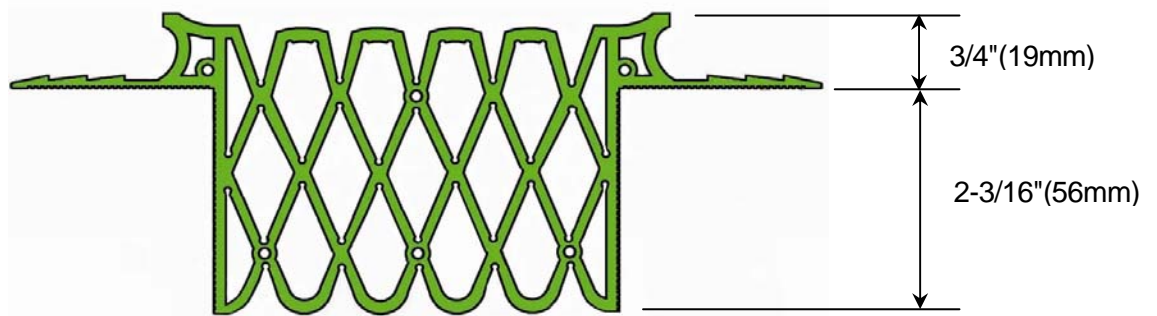

TECHNICAL BULLETIN 106

Subject: LokCrete Membrane Expansion Joint Systems (LMS-550 Series)
When to use the LMS-550HD (Heavy Duty) or the LMS-550LP (Low Profile) Seal?

The LokCrete Membrane System is a waterproof expansion joint system with impact absorbing elastomeric concrete that bonds a continuous elastoprene membrane seal to the concrete deck. This creates a high performance monolithic sealing system that prevents water intrusion. Each seal in the series has unique web wall configurations that maximize its movement characteristics (expansion, contraction, shear, and vertical displacement). The LMS-550 Series is available in two seal styles – the LMS-550HD and the LMS-550LP.



LMS- 550HD

The LMS-550HD seal profile is deeper than the LMS-550LP and is designed for wider expansion joint openings. The deeper style seal profile provides additional internal rubber cross-braced webs that provide maximum pedestrian foot traffic support.



LMS- 550LP

The LMS-550LP seal is a low profile design for wider expansion joint openings. The low profile seal design provides additional space in the expansion joint throat opening to accommodate fire barriers or conduit that may be required when the overall concrete slab thickness can not be adjusted. (See detail on the next page.)

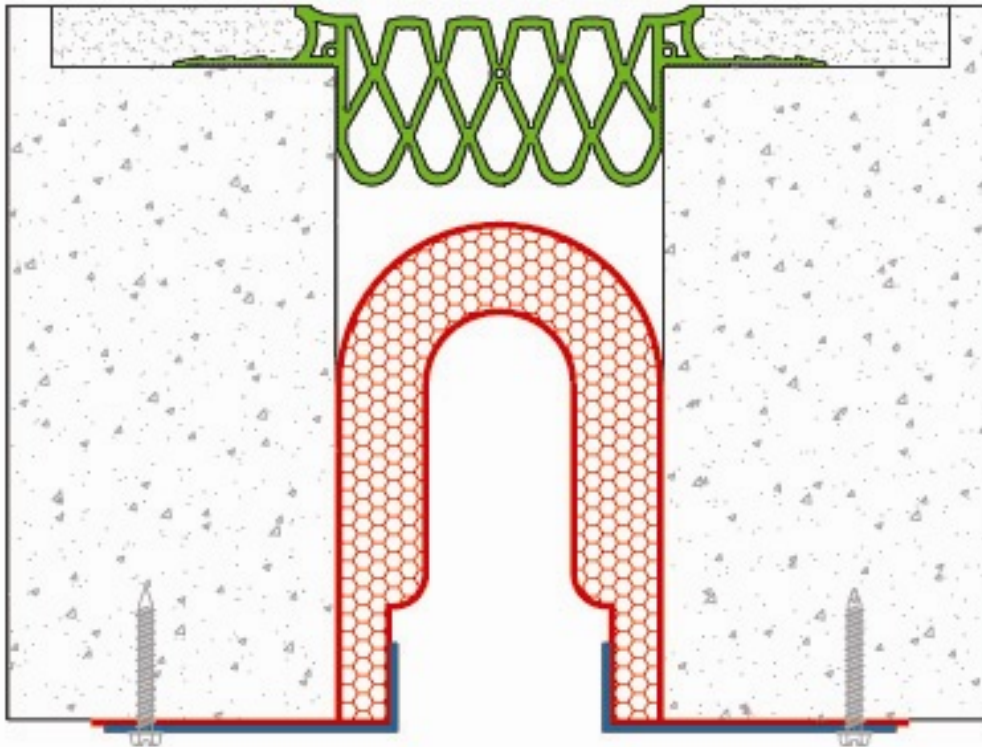

LMS- 550LP with PyroFlex Under-Slab Fire Barrier

The overall concrete deck thickness is dependent on two factors. The first factor is the maximum joint opening required (calculated or measured) after the expansion joint opening has cycled through its entire movement range. The second factor is the hourly rating for fire resistance that is stipulated by local building codes. In many areas the International Building Code is followed because it is the most comprehensive code when it comes to fire ratings. As the hourly resistance rating increases, so does the required rating of the surrounding construction. Therefore, a three hour fire rated concrete deck will be thicker than a two hour rated concrete deck. The fire barrier design will also change in order to accommodate the required hourly fire rating.

Contact MM Systems Corporation at 866-506-6929 to calculate and determine necessary concrete deck thickness and LMS-550 Seal Profile Type based on your specific project requirements.

See Technical Bulletin 101 for Performance Features of the LokCrete Membrane Expansion Joint System (LMS Series).

See System Selection Guide on the next page for listing of all LMS-550 seals and movement ranges.

LMS-550 SYSTEM SELECTION GUIDE

Model Number	Movement Range		Joint Opening "A"				Installation Range "A"						Depth "B" Clearance	
			Min.		Max.		Min.		Mid.		Max.			
LMS-550HD	5.00	133	1.50	32	6.50	165	2.75	70	3.875	98	5.25	133	3.25	83
LMS-C-550HD	5.00	133	1.50	32	6.50	165	2.75	70	3.875	98	5.25	133	3.25	83
LMS-550LP	5.00	133	1.50	32	6.50	165	2.75	70	3.875	98	5.25	133	2.50	64
LMS-C-550LP	5.00	133	1.50	32	6.50	165	2.75	70	3.875	98	5.25	133	2.50	64

Dimensions are shown in **inches** (bold) and millimeters.

Lateral Shear capability equal to values listed under Movement Range.

When specifying slab-to-wall condition add "C" after the model number (example: LMS-C-550HD)

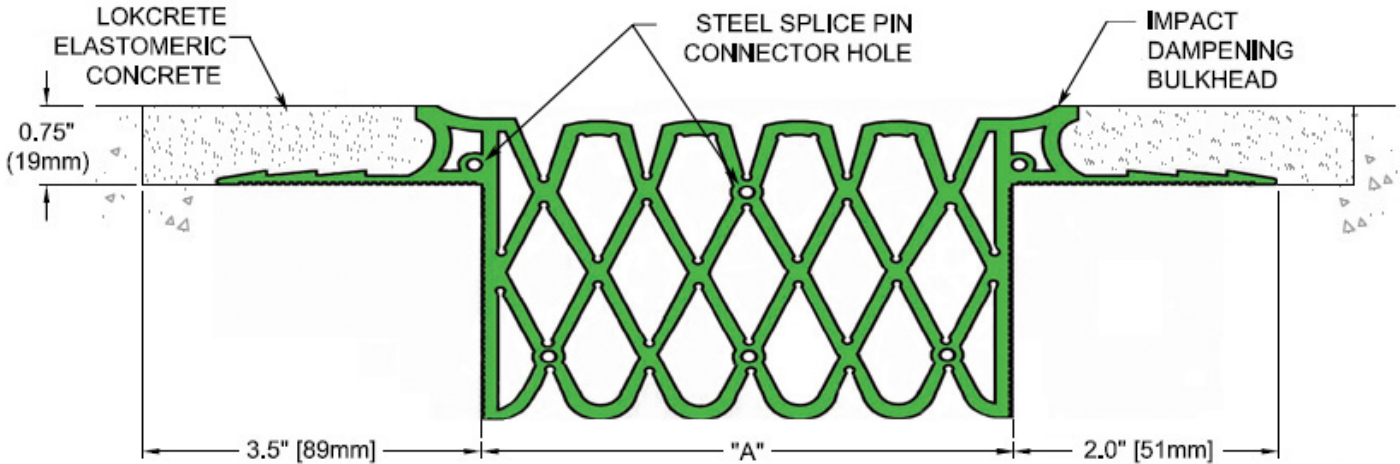

LMS-550HD (shown) / LMS-550LP (similar)

Note: As standard practice, MM Systems Corporation will supply the LMS-550HD Series unless otherwise specified on a project specific basis or as requested by the installation contractor.

MM Systems offers a comprehensive field-support program available to troubleshoot field problems, recommend remedial solutions and provide on-site expansion joint analysis. Our team includes: Field Application Engineers, Engineering Manger, Product Development Engineer and Parking Division General Manager.

For additional information or to schedule an AIA accredited continuing education seminar, contact MM Systems at 866-506-6929 for the nearest local representative.