

RUBBER SEAL PROFILES

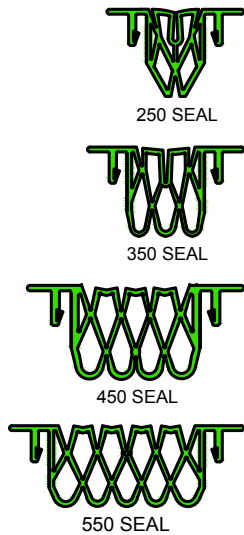

| Model Number | Nominal (JO _N) | | Nominal (SL _N) | | Thermal Movement (JO _T) | | | | Seismic Movement (JO _S) | | | | Total (JO _A) Movement | |
|--------------|----------------------------|---------|----------------------------|---------|-------------------------------------|---------|-------------|---------|-------------------------------------|---------|-------------|---------|-----------------------------------|-----|
| | Minimum | Maximum | Minimum | Maximum | Minimum | Maximum | Minimum | Maximum | Minimum | Maximum | Minimum | Maximum | | |
| SSM-250TM | 1.50 | 38 | 4.50 | 114 | 0.75 | 19 | 2.50 | 64 | 0.75 | 19 | 3.25 | 83 | 2.50 | 64 |
| SSM-350TM | 2.00 | 57 | 5.00 | 127 | 1.00 | 25 | 3.50 | 89 | 1.00 | 25 | 4.25 | 108 | 3.25 | 83 |
| SSM-450TM | 3.00 | 76 | 6.00 | 152 | 1.50 | 38 | 4.50 | 114 | 1.50 | 38 | 5.50 | 140 | 4.00 | 102 |
| SSM-550TM | 4.00 | 102 | 7.00 | 178 | 1.50 | 38 | 5.50 | 140 | 1.50 | 38 | 6.50 | 165 | 5.00 | 127 |

Dimension shown in inches (bold) and millimeters. JO = Joint Opening. SL = Sight Line. Color Options for rubber seals are Black or Special Order Gray.

| Base Angle Size | System Height (SH) | |
|-----------------|--------------------|-----|
| 4 x 1.75 | 3.00 | 76 |
| 4 x 2 | 3.25 | 83 |
| 4 x 2.25 | 3.50 | 89 |
| 4 x 2.5 | 3.75 | 95 |
| 4 x 2.75 | 4.00 | 102 |
| 4 x 3 | 4.25 | 108 |
| 4 x 3.25 | 4.50 | 114 |
| 4 x 3.5 | 4.75 | 121 |
| 4 x 3.75 | 5.00 | 127 |
| 4 x 4 | 5.25 | 133 |
| 4 x 4.25 | 5.50 | 140 |
| 4 x 4.5 | 5.75 | 146 |
| 4 x 4.75 | 6.00 | 152 |

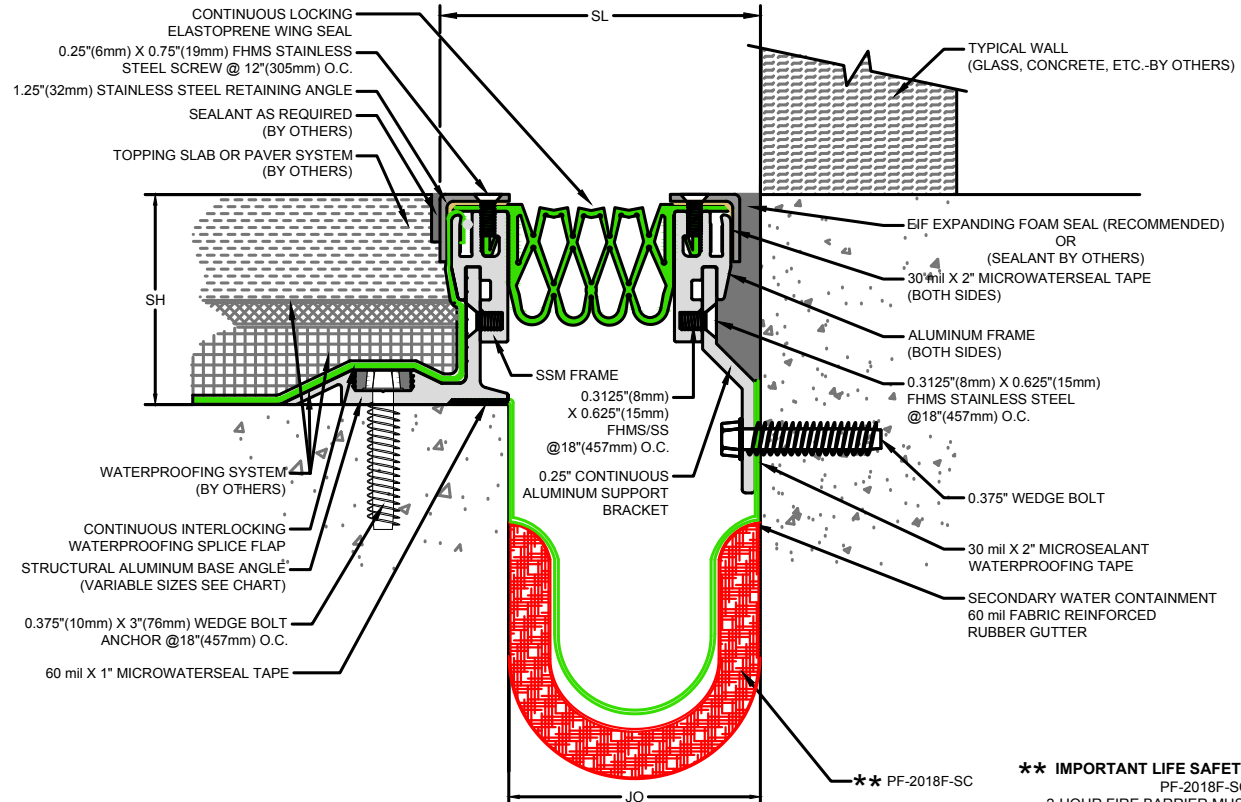

SSM-TM Series Expansion Joint
(Slab-to-Throat Mount)

**** IMPORTANT LIFE SAFETY PRODUCT NOTE**
PF-2018F-SC
2-HOUR FIRE BARRIER MUST BE INSTALLED IN 2-HOUR RATED SLAB WITH MINIMUM 4.50\"/>



50 MM WAY
PENDERGRASS, GA. 30567
706-824-7500 PHONE
866-506-6929 TOLL FREE
706-824-7501 FAX

www.mm-usa.com

For Spec-Data, Install Guides and other data visit www.mm-usa.com.

RIGHTS OF DESIGN

All rights of design, detail, engineering and/or invention contained herein are the property of MM Systems Corporation and hereby reserved and are not to be reproduced or provided to any other party. MM Systems Corporation reserves the right to amend or withdraw any information contained herein without notice and will not be liable for any inaccuracy or ambiguity of said information.

Split Slab Membrane System Expansion Joint
SSM Throat Mount Fire Rated

| | | |
|------------------|---------------------------|------------------------------------|
| Drawn by: DMW | Scale: NTS | Drawing Number: 41203-05 |
| SHT. 1 OF 1 | Issue Date: 07-14-2017 | |