

RUBBER SEAL PROFILES

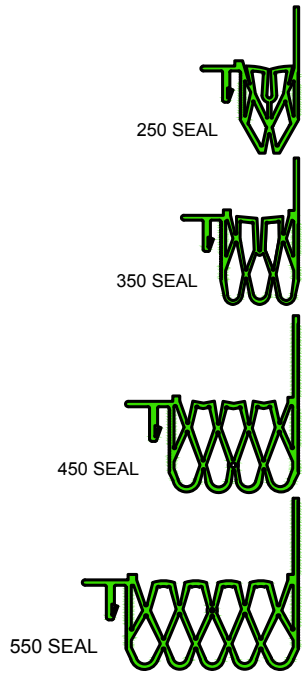

Model Number	Nominal (JO _N)		Nominal (SL _N)		Thermal Movement (JO _T)				Seismic Movement (JO _S)				Total (JO _A)	
	Minimum	Maximum	Minimum	Maximum	Minimum	Maximum	Minimum	Maximum	Minimum	Maximum	Minimum	Maximum		
SSM-C-250LP	1.50	38	3.00	76	0.75	19	2.50	64	0.75	19	3.25	83	2.50	64
SSM-C-350LP	2.25	57	3.50	89	1.00	25	3.50	89	1.00	25	4.25	108	3.25	83
SSM-C-450LP	3.00	76	4.25	108	1.50	38	4.50	114	1.50	38	5.50	140	4.00	102
SSM-C-550LP	4.00	102	5.25	133	1.50	38	5.50	140	1.50	38	6.50	165	5.00	127

Dimension shown in inches (bold) and millimeters. JO = Joint Opening. SL = Sight Line. Color Options for rubber seals are Black or Special Order Gray.

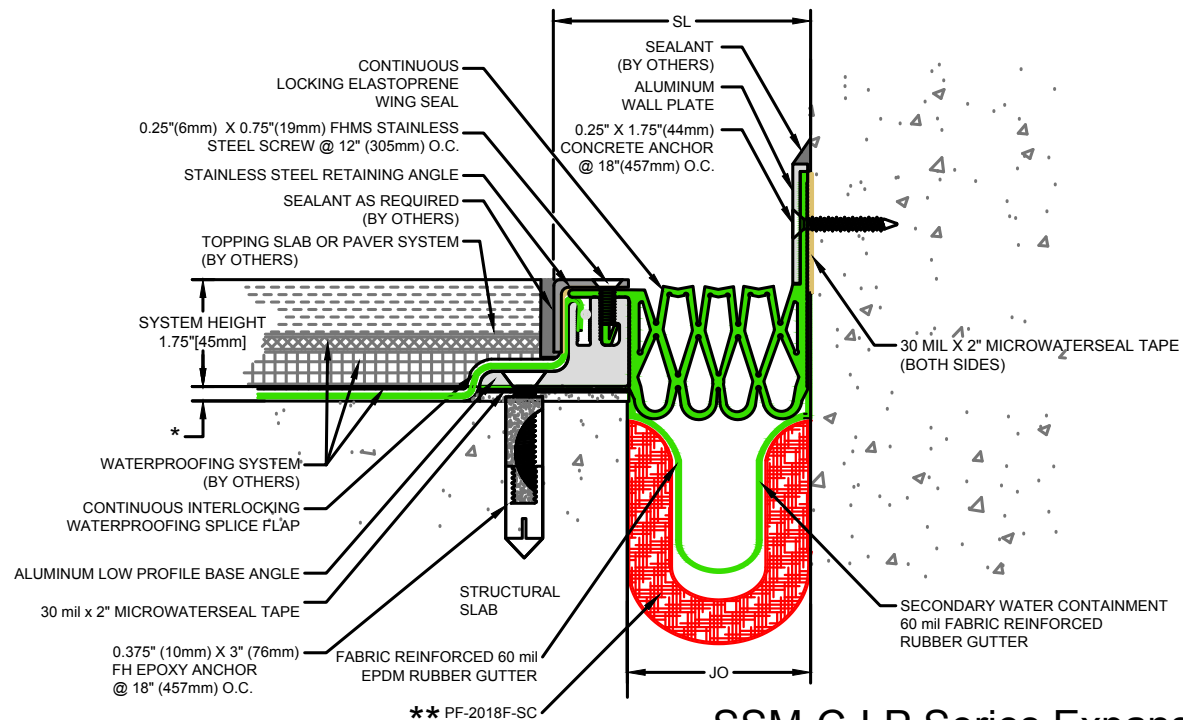

SSM-C-LP Series Expansion Joint
(Slab-to-Wall)

**** IMPORTANT LIFE SAFETY PRODUCT NOTE**
PF-2018F-SC
 PF-2018F-SC
 2-HOUR FIRE BARRIER MUST BE INSTALLED IN 2-HOUR RATED SLAB WITH MINIMUM 4.50" JOINT FACE. BARRIERS MUST BE INSTALLED IN STRICT ACCORDANCE WITH MM SYSTEMS FIRE BARRIER INSTALLATION INSTRUCTIONS AND IN ACCORDANCE TO IBC TABLE 721.2.2.1 "MINIMUM SLAB THICKNESS" (CONTACT FACTORY FOR OTHER STYLES OF FIRE BARRIER)

* NOTE: LEVELING BED (BY OTHERS) ADJUSTED IN FIELD AS NECESSARY TO ACHIEVE PROPER ELEVATION



50 MM WAY
 PENDERGRASS, GA. 30567
 706-824-7500 PHONE
 866-506-6929 TOLL FREE
 706-824-7501 FAX

www.mm-usa.com

For Spec-Data, Install Guides and other data visit www.mm-usa.com.

RIGHTS OF DESIGN

All rights of design, detail, engineering and/or invention contained herein are the property of MM Systems Corporation and hereby reserved and are not to be reproduced or provided to any other party. MM Systems Corporation reserves the right to amend or withdraw any information contained herein without notice and will not be liable for any inaccuracy or ambiguity of said information.

Split Slab Membrane System Expansion Joint
SSM-C Low Profile Fire Rated

Drawn by: DMW	Scale: NTS	Drawing Number: 41203-04
SHT. 1 OF 1	Issue Date: 07-14-2017	