

* SELF EXPANDING IMPREGNATED
FOAM BLOCK EPOXY BONDED
(EIH SERIES)

SSM EXPANSION JOINT
(SEE DRAWING 41200-01)

TOPPING SLAB OR
PAVER SYSTEM
(BY OTHERS)

STRUCTURAL SLAB

* WARNING: THE STRUCTURAL
EXPANSION JOINT OPENING
IN THE DECK MUST TRANSITION
INTO A VERTICAL STRUCTURAL
OPENING. OTHERWISE SEVERE
CRACKING MAY OCCUR.

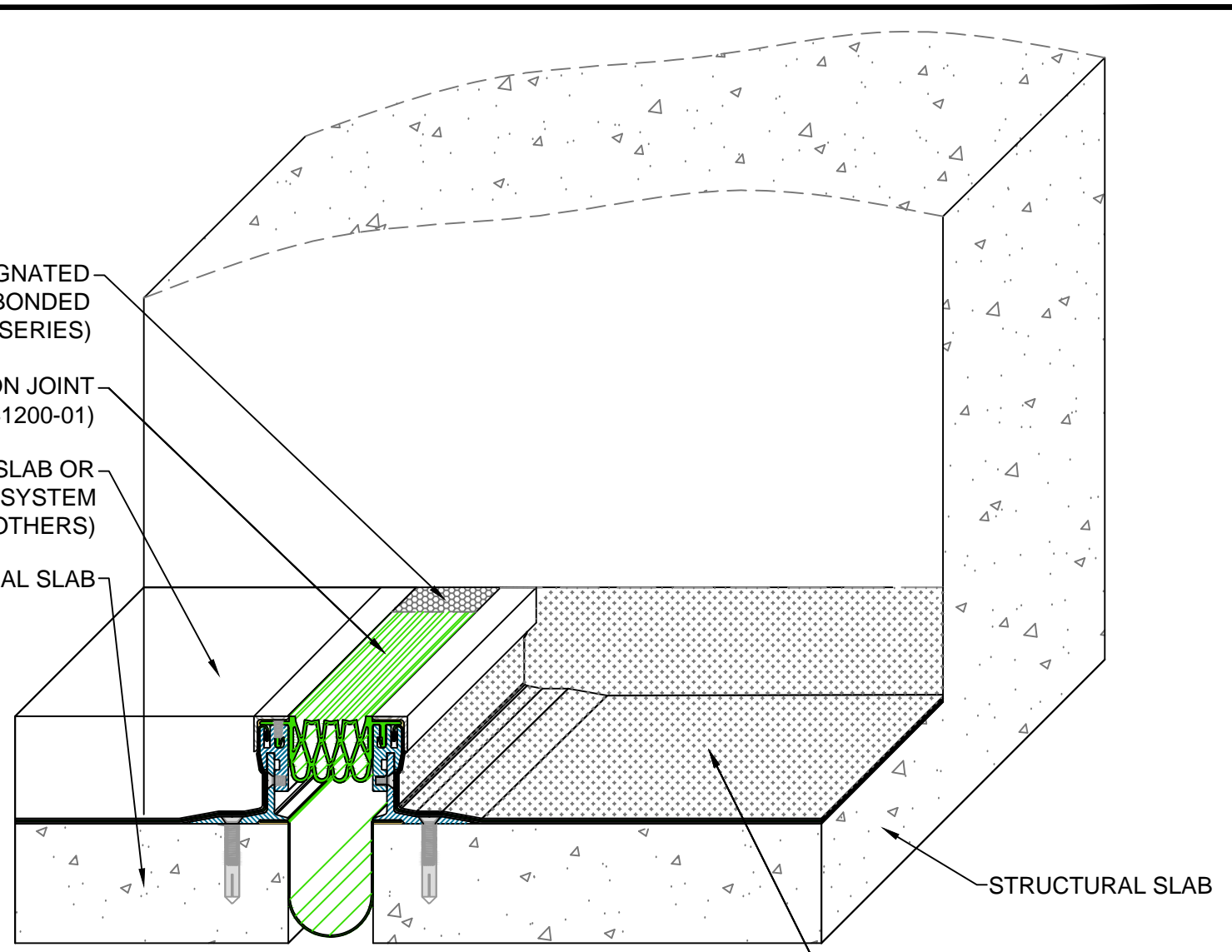

SSM End Termination Expansion Joint
(Transition)

STRUCTURAL SLAB
WATERPROOFING (BY OTHERS)
COVERS STRUCTURAL SLAB
AND TURNS UP WALL



MM
MM SYSTEMS

50 MM WAY
PENDERGRASS, GA. 30567
PHONE: 706-824-7500
866-506-6929
FAX: 706-824-7501

www.mm-usa.com

For Spec-Data, Installation Guides, or movement requirements, contact MMSC

RIGHTS OF DESIGN

All rights of design, detail, engineering and/or invention contained herein are the property of MM Systems Corporation and hereby reserved and are not to be reproduced or provided to any other party. MM Systems Corporation reserves the right to amend or withdraw any information contained herein without notice and will not be liable for any inaccuracy or ambiguity of said information.

Split Slab Membrane System Expansion Joint
SSM End Termination Transition

Drawn by: DMW	Scale: NTS	Drawing Number: 31201-14
SHT. 1 OF 1	Issue Date: 11-14-2014	