

OUTSIDE CORNER

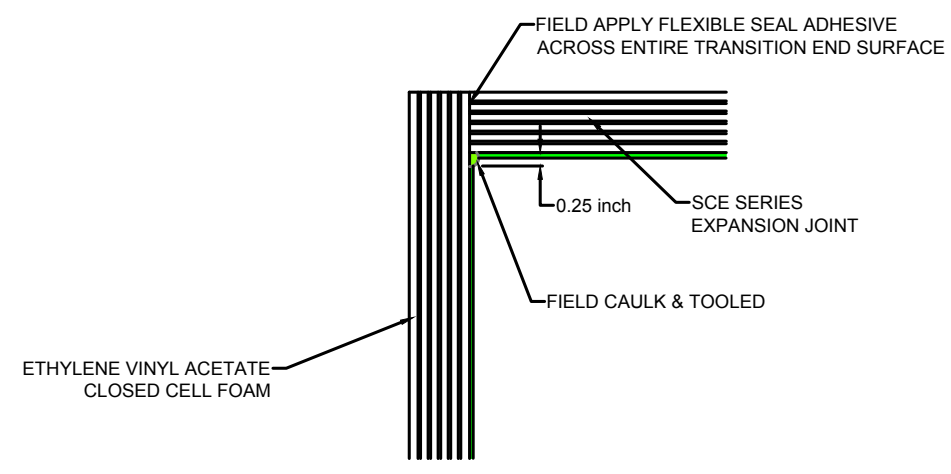

INSIDE CORNER

- NOTE:**
- INSURE BOTH ENDS ARE CUT SQUARE
 - USE HEAT PLATINUM TO SPLICE ENDS TOGETHER.
 - ALTERNATE SPLICING METHOD - FIELD APPLY FLEXIBLE SEAL ADHESIVE ACROSS ENTIRE BUTT END SURFACE
 - PUSH NEXT SECTION OF EVA INTO PREVIOUS SECTION CREATING A 0.25"[6mm] COMPRESSED INTERFERENCE FIT
 - REMOVE EXCESS ADHESIVE FROM FACE OF SEAL

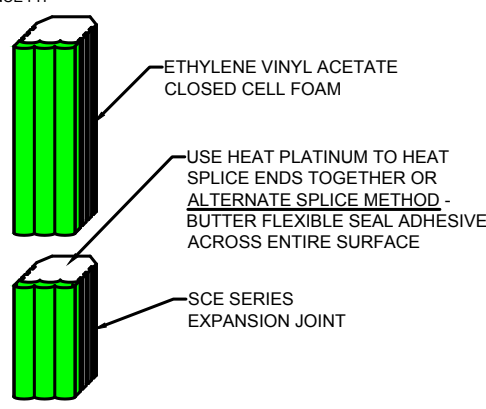

VERTICAL BUTT-SPLICE

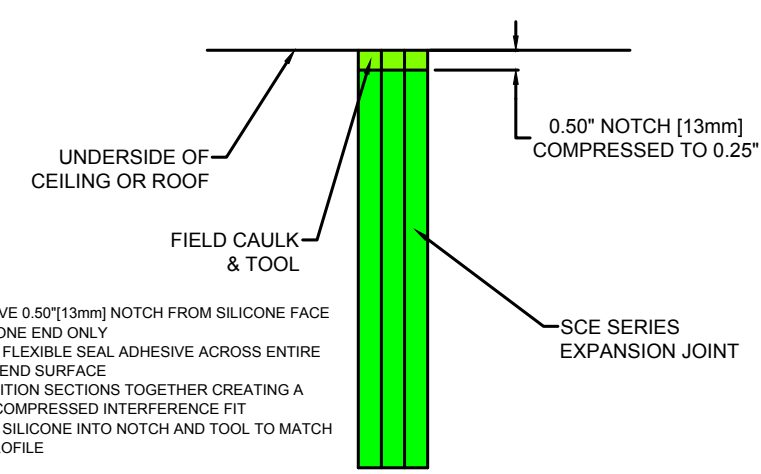

- NOTE:**
- CUT & REMOVE 0.50"[13mm] NOTCH FROM SILICONE FACE SEAL FROM ONE END ONLY
 - FIELD APPLY FLEXIBLE SEAL ADHESIVE ACROSS ENTIRE TRANSITION END SURFACE
 - PUSH TRANSITION SECTIONS TOGETHER CREATING A 0.125"[3mm] COMPRESSED INTERFERENCE FIT
 - FIELD APPLY SILICONE INTO NOTCH AND TOOL TO MATCH BELLOWS PROFILE

END TERMINATION



50 MM WAY
 PENDERGRASS, GA. 30567
 706-824-7500 PHONE
 800-241-3460 TOLL FREE
 706-824-7501 FAX

www.mm-usa.com

For Spec-Data, Install Guides, and other data visit www.mm-usa.com

RIGHTS OF DESIGN

All rights of design, detail, engineering and/or invention contained herein are the property of MM Systems Corporation and hereby reserved and are not to be reproduced or provided to any other party. MM Systems Corporation reserves the right to amend or withdraw any information contained herein without notice and will not be liable for any inaccuracy or ambiguity of said information.

Silicone Covered Ethylene Acetate Copolymer Foam Expansion Joint

SCE Vertical Transition

Drawn by: DMW	Scale: NTS	Drawing Number: 31226-01
SHT. 1 OF 2	Issue Date: 07-12-2017	

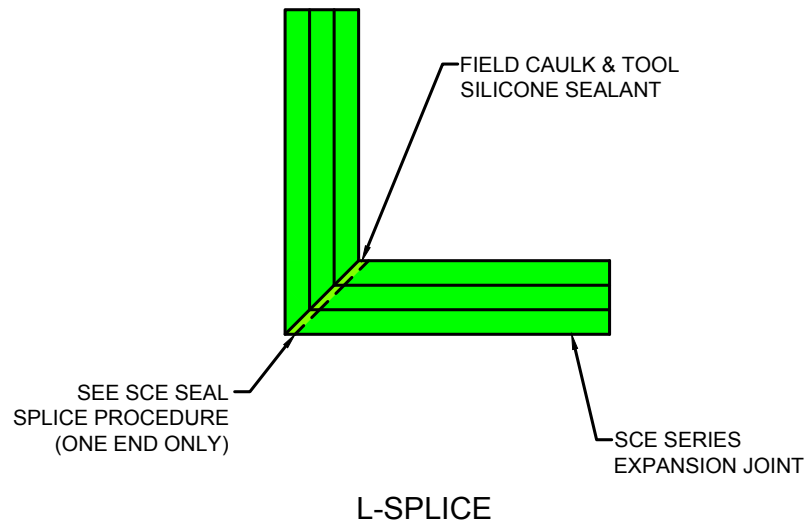

NOTE:

- CUT & REMOVE 0.25"[6mm] NOTCH FROM SILICONE FACE SEAL FROM ONE END ONLY
- USE HEAT PLATINUM TO SPLICE ENDS TOGETHER.
- ALTERNATE SPLICING METHOD - FIELD APPLY FLEXIBLE SEAL ADHESIVE ACROSS ENTIRE BUTT END SURFACE
- PUSH TRANSITION SECTIONS TOGETHER CREATING A 0.125"[3mm] COMPRESSED INTERFERENCE FIT
- FIELD APPLY SILICONE INTO NOTCH AND TOOL TO MATCH BELLOWS PROFILE

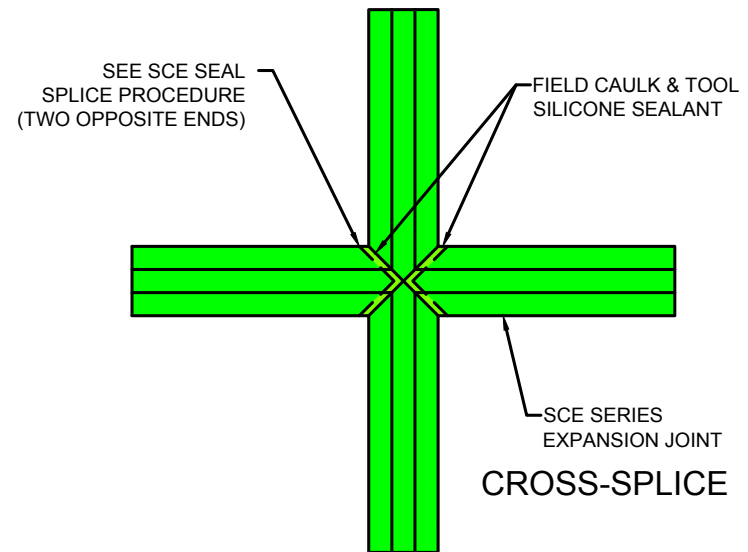
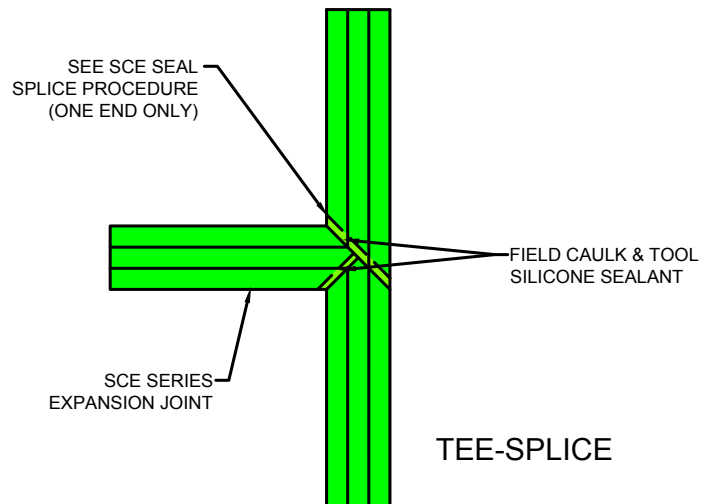
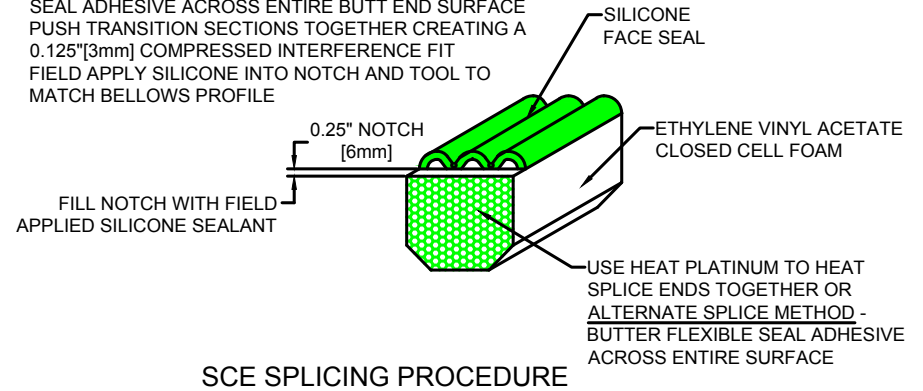

50 MM WAY
 PENDERGRASS, GA. 30567
 706-824-7500 PHONE
 800-241-3460 TOLL FREE
 706-824-7501 FAX

www.mm-usa.com

For Spec-Data, Install Guides, and other data visit www.mm-usa.com

RIGHTS OF DESIGN

All rights of design, detail, engineering and/or invention contained herein are the property of MM Systems Corporation and hereby reserved and are not to be reproduced or provided to any other party. MM Systems Corporation reserves the right to amend or withdraw any information contained herein without notice and will not be liable for any inaccuracy or ambiguity of said information.

Silicone Covered Ethylene Acetate Copolymer Foam Expansion Joint

SCE Vertical Transition

Drawn by: DMW	Scale: NTS	Drawing Number:
SHT. 2 OF 2	Issue Date: 07-12-2017	31226-01