

Model Number	Nominal (JO _N)		Nominal (SL _N)		Thermal Movement (JO _T)				Seismic Movement (JO _S)				Total (JO _Δ)		Seal Depth (SD)	
	Minimum	Maximum	Minimum	Maximum	Minimum	Maximum	Minimum	Maximum	Minimum	Maximum	Minimum	Maximum	Minimum	Maximum		
EBS-100	1.00	25	1.00	25	0.500	13	1.50	38	0.50	13	1.75	44	1.25	32	1.500	38
EBS-150	1.50	38	1.50	38	0.750	19	2.25	57	0.75	19	2.50	64	1.75	44	2.500	64
EBS-200	2.00	51	2.00	51	1.250	32	2.75	70	1.25	32	3.00	76	1.75	44	2.625	67
EBS-250	2.50	64	2.50	64	1.375	35	3.50	89	1.375	35	4.00	102	2.625	67	3.000	76
EBS-300	3.00	76	3.00	76	1.500	38	4.50	114	1.50	38	5.00	127	3.50	89	3.000	76
EBS-400	4.00	102	4.00	102	1.750	44	5.50	140	1.75	44	6.25	159	4.50	114	3.000	76

Dimension shown in inches (bold) and millimeters. JO = Joint Opening. SL = Sight Line. Color Options for rubber seals are Black or Special Order Gray.

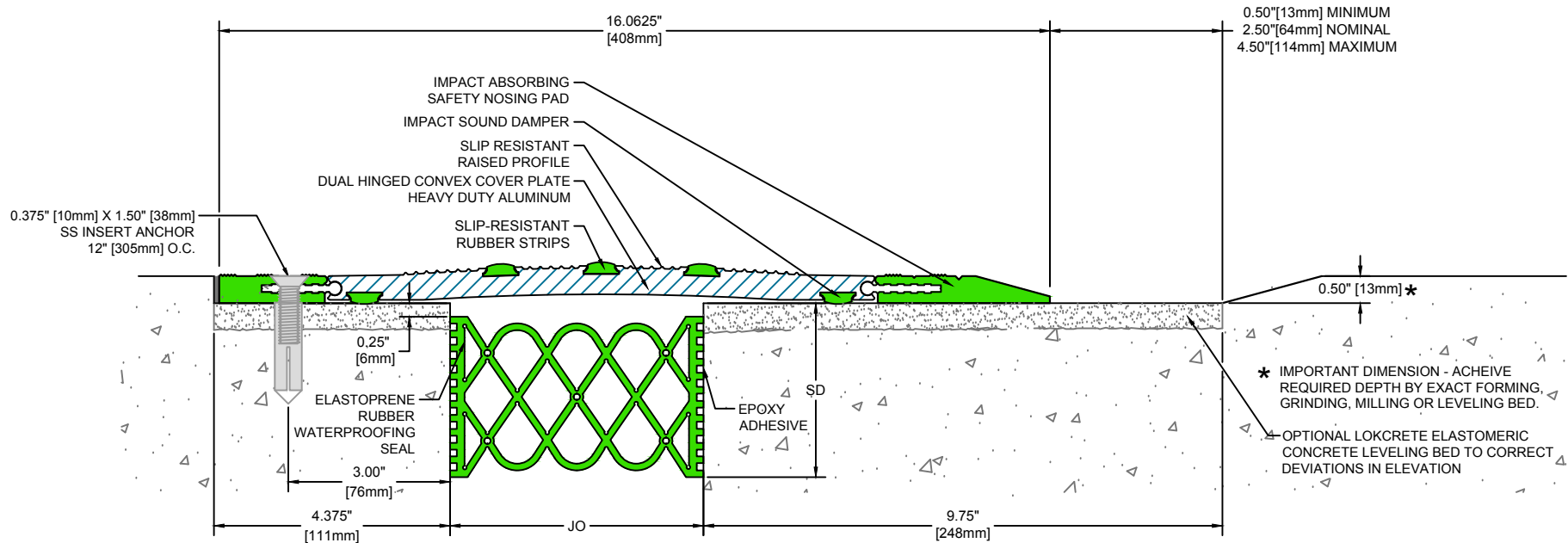

NOTE:
RUBBER SAFETY COVER IS CAPABLE
OF ACCOMMODATING BOTH PEDESTRIAN
AND VEHICULAR LOADING.

EBS with RSC-850 Recessed Expansion Joint Cover (Slab-to-Slab)



50 MM WAY
PENDERGRASS, GA. 30567
706-824-7500 PHONE
800-241-3460 TOLL FREE
706-824-7501 FAX

www.mm-usa.com

For Spec-Data, Install Guides, and other data visit www.mm-usa.com

RIGHTS OF DESIGN

All rights of design, detail, engineering and/or invention contained herein are the property of MM Systems Corporation and hereby reserved and are not to be reproduced or provided to any other party. MM Systems Corporation reserves the right to amend or withdraw any information contained herein without notice and will not be liable for any inaccuracy or ambiguity of said information.

Epoxy Bonded Sealing Expansion Joint EBS with RSC Recessed Cover

Drawn by:
DMW

Scale:
NTS

Drawing Number:

SHT. 1 OF 1

Issue Date:
03-10-2016

30302-01