

**IMPORTANT LIFE SAFETY NOTE**  
 NOTE 2 BARRIERS REQUIRED.  
 MINIMUM WALL DEPTH REQUIRED FOR RATING:  
 6.75" FOR SINGLE SIDE INSTALLATION (SHOWN)  
 6.75" FOR DUAL SIDE INSTALLATION  
 ARCHITECT / CONTRACTOR MUST VERIFY PRIOR  
 TO FABRICATION

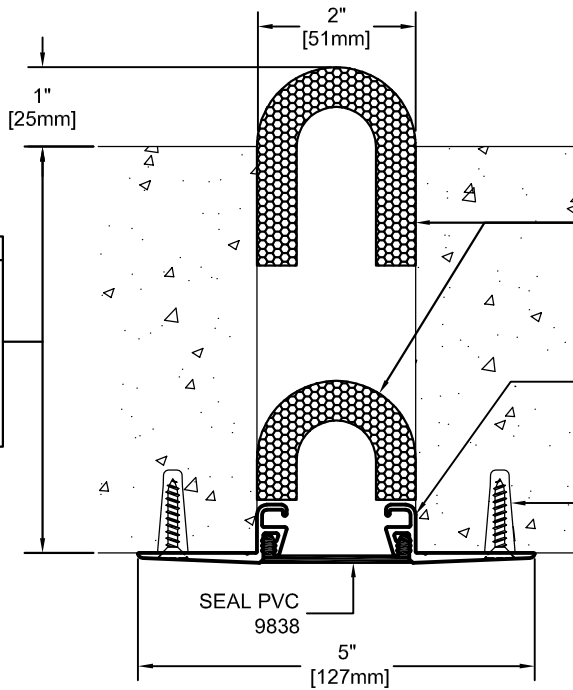

**IMPORTANT LIFE SAFETY PRODUCT NOTE**  
 PF-2018CW-SC-2-1  
 TO ACHIEVE RATING, 2-HOUR FIRE BARRIER  
 MUST BE INSTALLED IN 2-HOUR RATED WALL.  
 BARRIERS MUST BE INSTALLED IN STRICT  
 ACCORDANCE WITH TYPICAL WALL FIRE  
 BARRIER INSTALLATION INSTRUCTIONS  
 PROVIDED IN THIS SUBMITTAL.

ALUMINUM FRAME  
 (137)  
 8802  
 #10 X 1" FHMS/SS &  
 #10 - 12 X 1" ANCHOR  
 PLASTIC INSERT  
 @ 24" O.C. [610mm]  
 9351 & 9357

Model	Nominal "JT"	Joint Opening "JT"				Total Movement	Mat. Code
		Seismic Min.	Thermal Min.	Thermal Max.	Seismic Max.		
FSA-200_CONC_2HWPF_SS	2"	1.375"	1.5"	2.25"	2.5625"	1.1875"	FE5103

**ARCHITECT/CONTRACTOR NOTE:**  
 ALL SUBASSEMBLY COMPONENTS TO BE  
 PROVIDED IN 10'-0" OR 20'-0" STOCK LENGTHS  
 UNLESS OTHERWISE NOTED. THE SPECIFIC  
 SYSTEMS DICTATE THE LENGTHS PROVIDED.

Approved by: \_\_\_\_\_ Date: \_\_\_\_\_  
**SEAL NOTE: SPECIFY SEAL COLOR**  
 STANDARD COLORS:  
 CARBON (BLACK)       PRAIRIE (BEIGE)  
 FOG (GRAY)             LUNAR (WHITE)  
\*CUSTOM COLOR AVAILABLE IN MINIMUM QUANTITIES 100 LF.  
 CONTACT MM FOR PRICING & AVAILABILITY.

Representative: \_\_\_\_\_ Customer: \_\_\_\_\_ Project: \_\_\_\_\_ Location: \_\_\_\_\_ Project Number: \_\_\_\_\_

**MM SYSTEMS**  
 50 MM WAY  
 PENDERGRASS, GA. 30567  
 PHONE: 706-824-7500  
 800-241-3460  
 FAX: 706-824-7501  
[www.mmsystemscorp.com](http://www.mmsystemscorp.com)  
 For Spec-Data, Installation Guides, or movement requirements, contact MMSC

**RIGHTS OF DESIGN**  
 All rights of design, detail, engineering and/or  
 invention contained herein are the property of MM  
 Systems Corporation and hereby reserved and are not  
 to be reproduced or provided to any other party. MM  
 Systems Corporation reserves the right to amend or  
 withdraw any information contained herein without  
 notice and will not be liable for any inaccuracy or  
 ambiguity of said information.

**FSA-200\_CONC\_2HWPF\_SS**  
 Model:  
 Drawn by: LMP Scale: NTS Drawing Number: FE5103  
 SHT. . OF . Issue Date: 12-29-11